

Christian Dering

28092

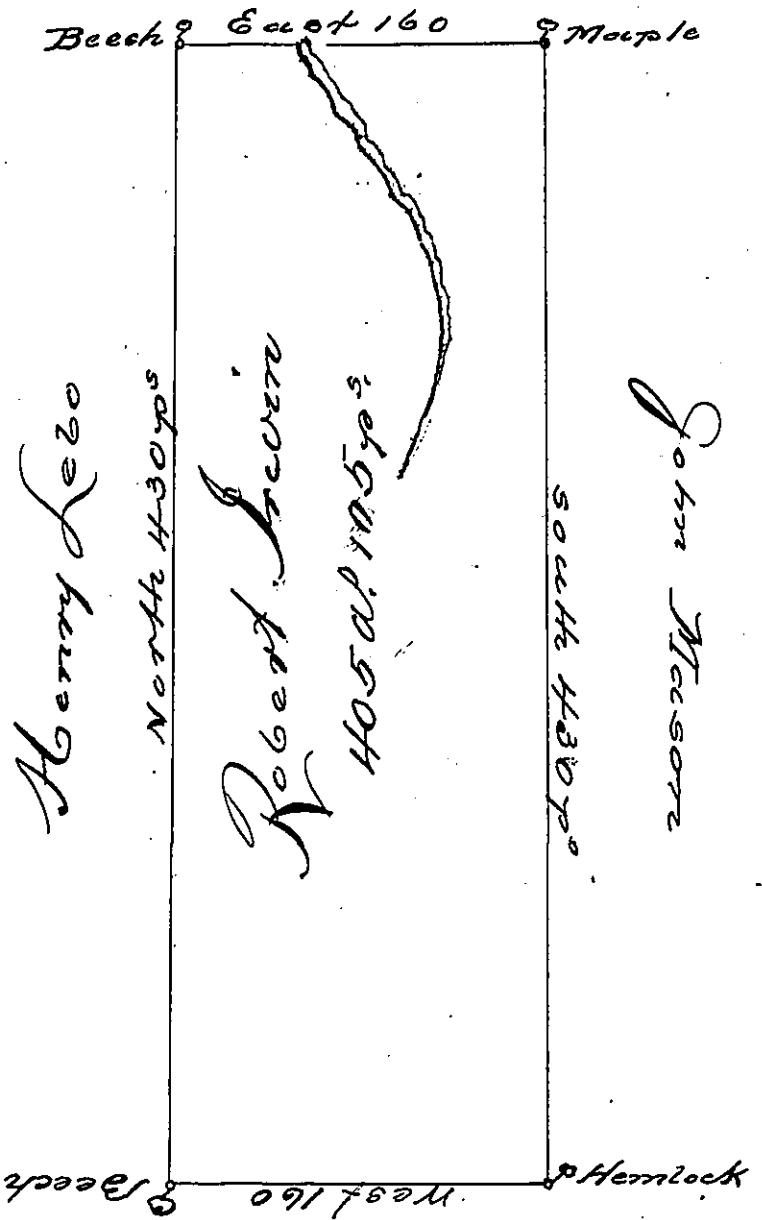

Situated on the waters of ^{Old Cerrys} Two Lick Creek in Wheat-
 field Township Westmoreland County, containing 405
 acres and 105 perches and allowed for Roads &c. Resurveyed
 the 25 day of Novem. 1794 for Robert Irwin, on
 warrant dated the 3 day of May 1793.

To Daniel Broadhead Esq.
 J. G.

James Ross d. J.

IN TESTIMONY that the above is a copy of the original remaining on file in
 the Department of Internal Affairs of Pennsylvania, made
 conformably to an Act of Assembly approved the 16th day of
 February, 1833, I have hereunto set my Hand and caused
 the Seal of said Department to be affixed at Harrisburg,
 this seventh day of May, 1901,

James [Signature]
 Secretary of Internal Affairs.